

ReefKeeper Lite

Quick Start Guide



More Information

Digital Aquatics has taken the lead in customer support with a number of options to suit your busy life.

E-mail Support

When you need help and can't call in, e-mail any time and we'll respond within one business day.

E-mail: support@digitalaquatics.com

Forum Support

We update and maintain the largest knowledge base of any controller company on our own dedicated support forum. The support forum is a great place to search for answers, ask questions, and get help, advice and suggestions from our very large and experienced customer base and Digital Aquatics staff members.

Forum: www.forum.digitalaquatics.com

Product Warranty

Digital Aquatics offers an industry leading two year warranty on all system head units and modules against manufacturer's defects. Units will be repaired or replaced (at our discretion) in compliance with our warranty program. This does not cover water damage, abuse, or shipping damage.

Digital Aquatics probes and accessories have warranties ranging from 1 year to 90 days depending on the item. This covers the product from manufactures defects.

Complete warranty details can be found on our support forum at www.forum.digitalaquatics.com

RKL BASIC

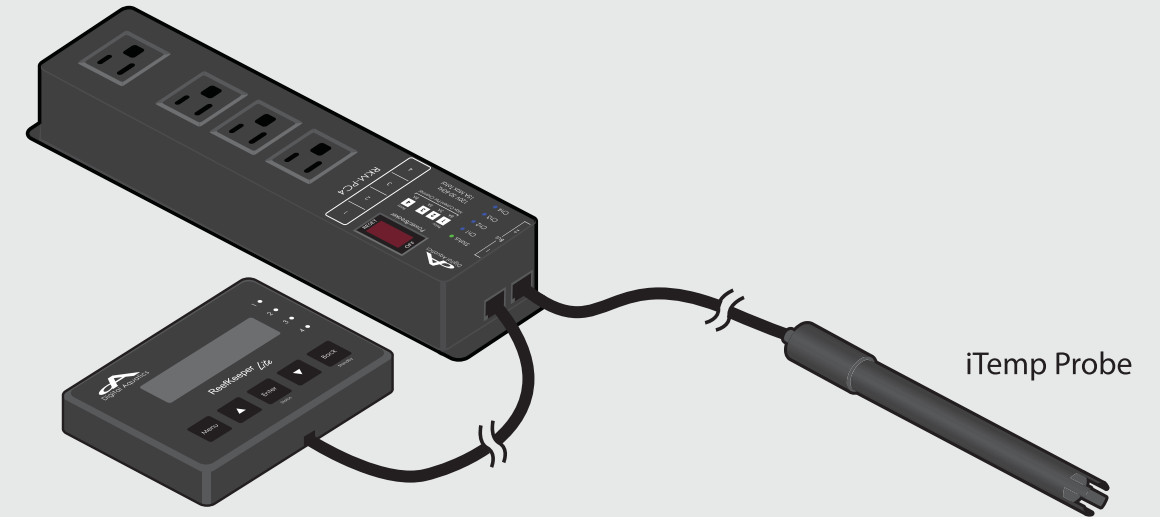

RKL BASIC: Connection Example

RKL PLUS

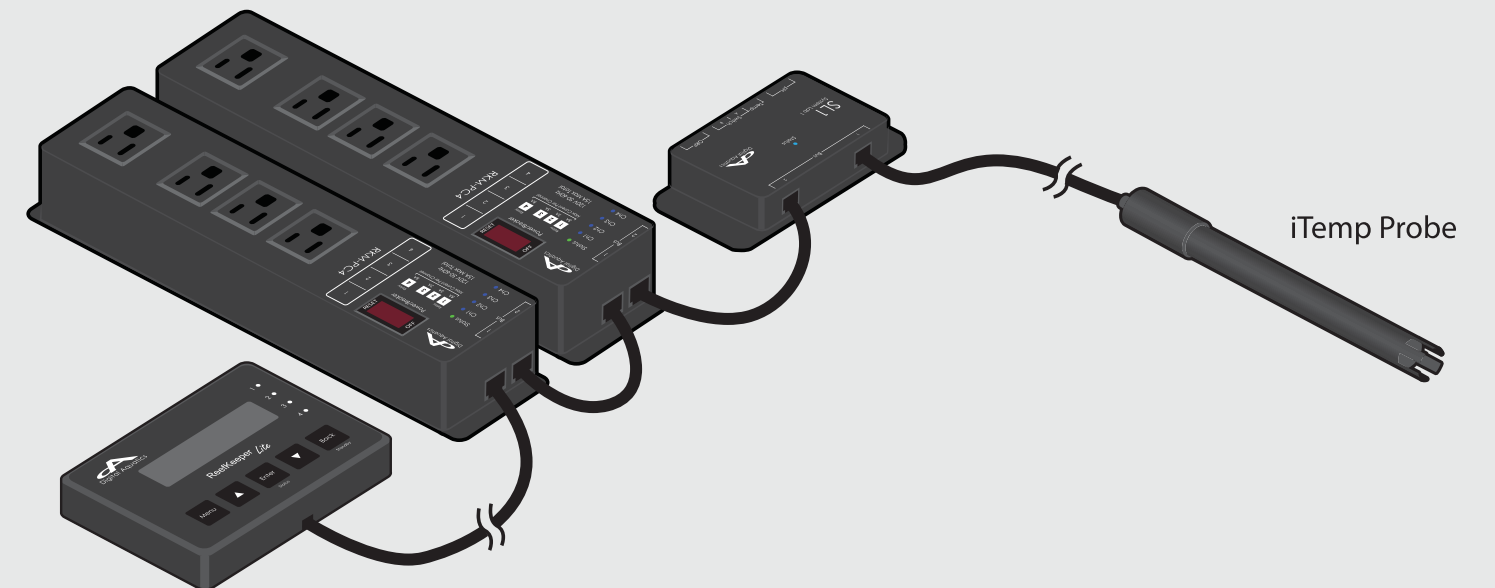

RKL PLUS: Connection Example

RKL BASIC: Package Contents

- 1 x RKL Head unit
- 1 x PC4 Module
- 1 x SID *
- 1 x iTemp Probe
- 4 x Mounting Screws *

* Not shown in image

RKL PLUS: Package Contents

- | | |
|-------------------|--------------------------|
| 1 x RKL Head unit | 1 x 7 pH Cal Solution * |
| 2 x PC4 Module | 1 x 10 pH Cal Solution * |
| 1 x SL1 Module | 1 x 3Ft Bus Cable |
| 1 x SID * | 1 x 6Ft Bus Cable |
| 1 x iTemp Probe | 8 x Mounting Screws * |
| 1 x pH Probe * | |

* Not shown in image

Getting Started

1

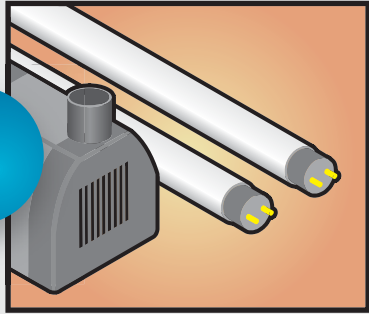

Pick a Device

Select a device you would like the RKL system to control, such as a light or pump.

2

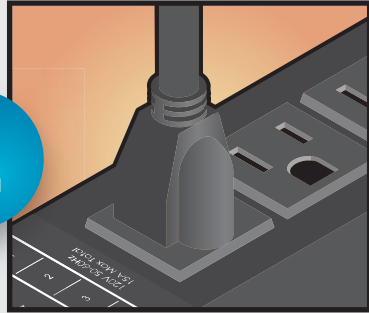

Select a Channel

Depending on the type of the device, select a channel on a PC4 and plug it in.

3



Program the Channel

Use the RKL to program the desired function to the channel in step 2. See the basic programming guide.

Basic Programming Guide*

How to set up a function...



Choosing the right function...

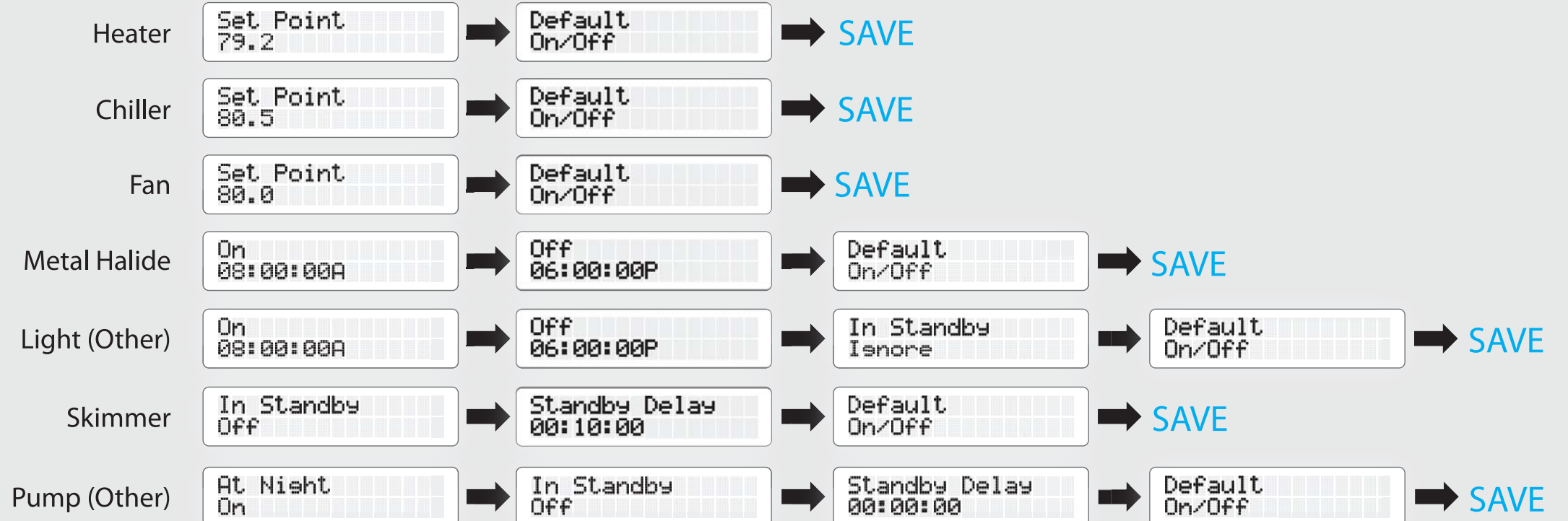

Mounting

Care and discretion should be used when installing your system modules. Proper installation practices should be used for continued safe operation. Never place or mount any module directly on the ground as doing so may allow water to flow down a cord and lead to a potential safety hazard or module failure. Even if you properly mount a module on a wall or cabinet, drip loops must be used to help reduce the risk of water intrusion into the unit.

GOOD

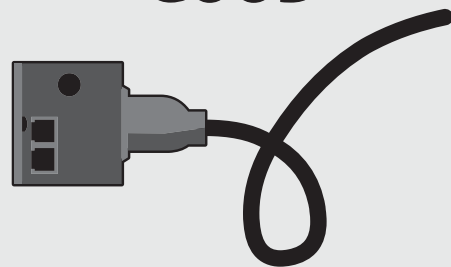

Correct Installation w/ Drip Loop

BAD

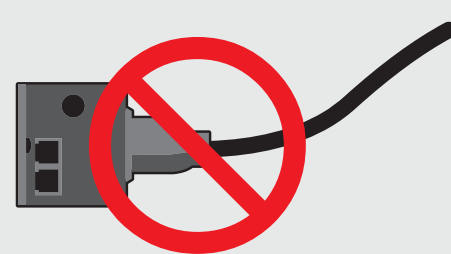

Incorrect Installation w/o Drip Loop

ReefKeeper Lite FAQs

- Q** My home screen displays "None". How can I change that?
A By pressing the [Up] or [Down] button you are able to cycle through the probes and outlets on your system and display the current status on the home screen. Once you come to the data that you want to view or display, you can leave it on the screen and it will continue to show that information.
- Q** What devices can I plug into my PC4 and is there a difference between the outlets?
A The PC4 can manage up to 15 amps (1800 Watts) of power. There are ratings for each channel printed on the PC4. Channels 1 & 4 are standard relays and are rated up to 8 amps each. Channels 2 & 3 are a different kind of switch and have a rating of 3 amps each. As long as you don't exceed the posted ratings on the channels (and the total on the PC4) you are free to plug almost any device into any outlet.
- Q** Can I expand my ReefKeeper Lite to take advantage of new modules and features?
A Yes! The ReefKeeper Lite can be expanded to monitor and control much more than what you may think. Refer to the Digital Aquatics catalog that came with your system or check out our website to see all the module and accessory options we offer.